

**Palapala Sila Nui Helu 2903
Puupai**

Ahupuaa o Pawili & Kealia, Mokupuni o Lanai.

E hoomaka ma he kihi Akau loa
o keia apana i ka waena konu
o kekahi opu Koli nui kihi
Komohana Hema o ko Kaaina
Aina kuai a e holo ana:

He. $14\frac{1}{2}^{\circ}$ Ko. 1620 pauku
me Aupuni;
He. 54° Hi. 3366 pauku me
Aupuni;
Ak. $21\frac{1}{4}^{\circ}$ Hi. 1512 pauku me
Aupuni;
Ak. $50\frac{1}{2}^{\circ}$ Ko. 970 pauku me
Kapahoa;
Ak. $54\frac{3}{4}^{\circ}$ Ko. 2606 pauku me
Kaaina;
Hiki i kahi hoomaka ai.

O kona ili 52.07/100 Eka.

[John Richardson]
Waikapu
Nov. 1855.

Translation:

Beginning at the far Northern
corner of this parcel, in the
middle of a large clump of
Castor plants, at the South
Eastern corner of land
Purchased by Kaaina, and
running:

South $14\frac{1}{2}^{\circ}$ West 1620 links
along Government land;
South 54° East 3366 links
along Government land;
North $21\frac{1}{4}^{\circ}$ East 1512 links
along Government land;
North $50\frac{1}{2}^{\circ}$ West 970 links
along Kapahoa;
North $54\frac{3}{4}^{\circ}$ West 2606 links
along Kaaina.

52.07 Acres. [Maly, translator]

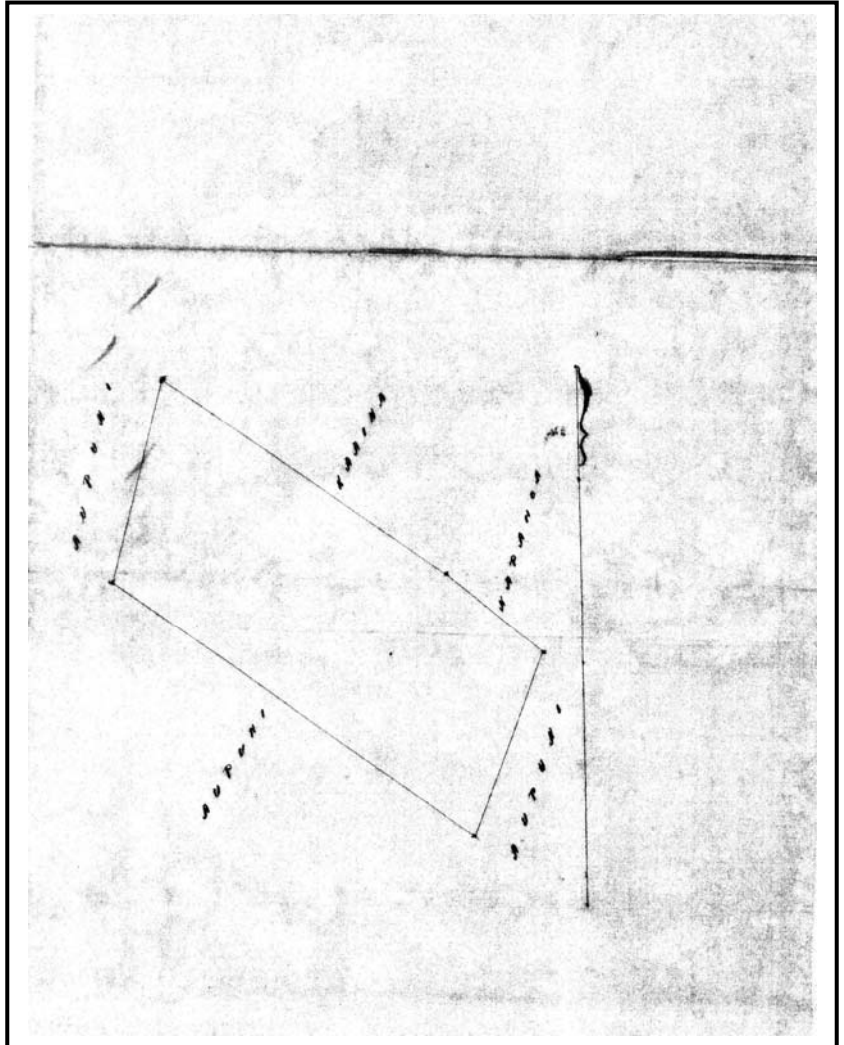

**Figure 6. Notes of Survey for Royal Patent Land Grant
No. 2903 to Puupai, at Pawili & Kealia
Aupuni. Hawaii State Archives.**

HELU 2903 ✓
PALAPALA SILA NUI.

Ma keia Palapala Sila Nui ke hiki aku nei o Kamehameha IV., ke Alii nui a ke Akua i kona lokomaikai i hoonoho ai maluna o ko Hawaii Pae Aina, i na kanaka a pau, i keia la, nona illo, a no kona mau hope Alii, na hāwii lilo loa aku ois ma ke ano aloha ia *Puuipai*

i kona kanaka i māno pono ia ia, i kela apau aina a
 pau e waiho la ma *Puwili & Kealia* ma ka Mokupuni o *Lanai* ; a penei hoi ka waiho ana o na Mokuna:

Lo houna ma na He Hehi Hehi o Heia apaua i ka waenakonu o Hehehi o He Hehi nui Hehi Kom. Heia o He Heia aiaa Heia, a e holo ana

<i>Heia</i>	<i>14 1/2'</i>	<i>Com</i>	<i>16 20</i>	<i>Heia Heia me Auferni</i>	
<i>Heia</i>	<i>5'</i>	<i>Heia</i>	<i>33 66</i>		
<i>Heia</i>	<i>2 1/2'</i>	<i>Heia</i>	<i>15 12</i>		
<i>Heia</i>	<i>50'</i>	<i>Heia</i>	<i>9 70</i>		<i>Kapahoa</i>
<i>Heia</i>	<i>54'</i>	<i>Heia</i>	<i>26 16</i>		<i>Heia</i>

i He Hehi Heia *— J. O. J.*

He Heia He Heia He Heia He Heia



NO. 462 A-1018-1863



a maloko o ia Apana *to 7/10* eka a oi iki aku emi iki mui paha.
 Eia ke kumu o ka lilo ana; ua haawi mai oia iloko o ka waihoia waiwai o ke Aupuni i
na hale ke #52.12
 Aka, ua koe i ke Aupuni na mine minerala a me na mine metala a pau.
 No *Puupai*
 ua nina la i haawha, noma mau loa aku no, ma ke ano alodio a no koma mau huuilina, a me ko
 na waihoia, ua pili nae ka 'uhau a ka Poe Aheolelo e kau like ai ma na nina alodio a pau i keia
 manawa i keia manawa.

A i mea e ikeai, ua kau wau i ko'u inoa, a me ka Sila Nui o ke Hawaii Pae Aina,
 ma Honolulu, i keia la *29* o *Samueli*, 1863

Kamehameha

Kiaakumana

Kamehameha